

■ DPGW-FW

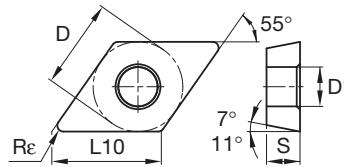

Номер по каталогу ISO	Номер по каталогу ANSI	D		L10		S		Rε		D1		K		N		S								
		мм	дюйм	мм	дюйм	мм	дюйм	мм	дюйм	мм	дюйм	KB1345	KB9640	KD1400	KD1405	KD1425	KB1610	KB1625	KB1630	KB5610	KB5625	KB5630	KB9610	
DPGW070204FWST	DPGW2151FWST	6,35	1/4	7,72	.304	2,38	3/32	0,2	.007	2,80	.110			●										
DPGW11T304FWST	DPGW3251FWST	9,53	3/8	11,59	.456	3,97	5/32	0,2	.007	4,40	.173			●										

■ DPGW-E/F

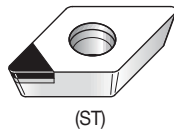
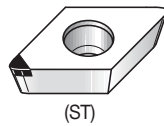

DPGW070202E	DPGW21505E	6,35	1/4	7,75	.305	2,38	3/32	0,2	.0080	2,80	.110				●									
DPGW070202FST	DPGW21505FST	6,35	1/4	7,75	.305	2,38	3/32	0,2	.0080	2,80	.110			●		●								
DPGW070204FST	DPGW2151FST	6,35	1/4	7,75	.305	2,38	3/32	0,4	1/64	2,80	.110			●		●								
DPGW11T304E	DPGW3251E	9,53	3/8	11,63	.458	3,97	5/32	0,4	1/64	4,40	.173				●									
DPGW11T304FST	DPGW3251FST	9,53	3/8	11,63	.458	3,97	5/32	0,4	1/64	4,40	.173			●		●								

■ DPGW-FW

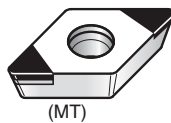
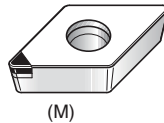

DPGW070204S01015FWM	DPGW2151S0415FWM	6,35	1/4	7,75	.305	2,38	3/32	0,4	1/64	2,80	.110													●
DPGW11T304EFWMT	DPGW3251EFWMT	9,53	3/8	11,63	.458	3,97	5/32	0,4	1/64	4,40	.173													●

■ DPGW

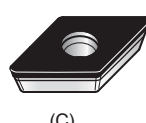
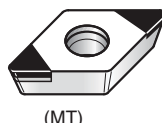
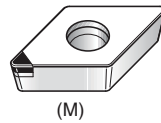

DPGW070202EM	DPGW21505EM	6,35	1/4	7,75	.305	2,38	3/32	0,2	.0080	2,80	.110														●	●
DPGW070202S01015C	DPGW21505S0415C	6,35	1/4	7,75	.305	2,38	3/32	0,2	.008	2,80	.110														●	●
DPGW070204EM	DPGW2151EM	6,35	1/4	7,75	.305	2,38	3/32	0,4	1/64	2,80	.110														●	●
DPGW070204S01015C	DPGW2151S0415C	6,35	1/4	7,75	.305	2,38	3/32	0,4	1/64	2,80	.110														●	●
DPGW070204S01015M	DPGW2151S0415M	6,35	1/4	7,75	.305	2,38	3/32	0,4	1/64	2,80	.110														●	●
DPGW070208S01015M	DPGW2152S0415M	6,35	1/4	7,75	.305	2,38	3/32	0,8	1/32	2,80	.110														●	●
DPGW11T304EMT	DPGW3251EMT	9,53	3/8	11,63	.458	3,97	5/32	0,4	1/64	4,40	.173														●	●
DPGW11T304S01015M	DPGW3251S0415M	9,53	3/8	11,63	.458	3,97	5/32	0,4	1/64	4,40	.173														●	●
DPGW11T304S01015MT	DPGW3251S0415MT	9,53	3/8	11,63	.458	3,97	5/32	0,4	1/64	4,40	.173														●	●
DPGW11T308EMT	DPGW3252EMT	9,53	3/8	11,63	.458	3,97	5/32	0,8	1/32	4,40	.173														●	●
DPGW11T308S01015M	DPGW3252S0415M	9,53	3/8	11,63	.458	3,97	5/32	0,8	1/32	4,40	.173														●	●
DPGW11T308S01015MT	DPGW3252S0415MT	9,53	3/8	11,63	.458	3,97	5/32	0,8	1/32	4,40	.173														●	●

Пример заказа:

Номер по каталогу ISO: DPGW070202EM

Номер по каталогу ANSI: DPGW21505EM

Марка детали: KB5625